

Model:	700.PE-03	800x700x900 [mm]
Power rating	9 kW	
Capacity	50 dm ³	
Working area	0.3 m ²	
Bowl dimensions	400x700x180 mm	
Rated voltage, type of current:	400V 3N~	
Water connection	1/2"	

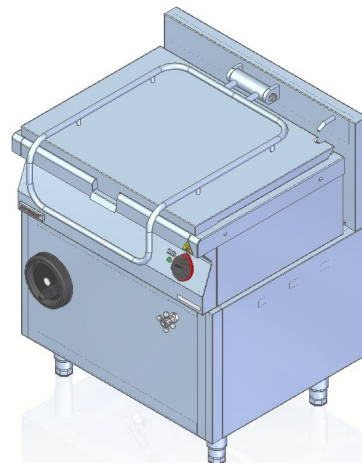

Description:

Electric pans are made of high-grade stainless steels. Working plate made of AISI 304 stainless steel with thickness ≠ 1.5mm. Bowl bottom ensures uniform temperature distribution. Pan with manual bowl-tilting. Water supply spout.

700.PE-03

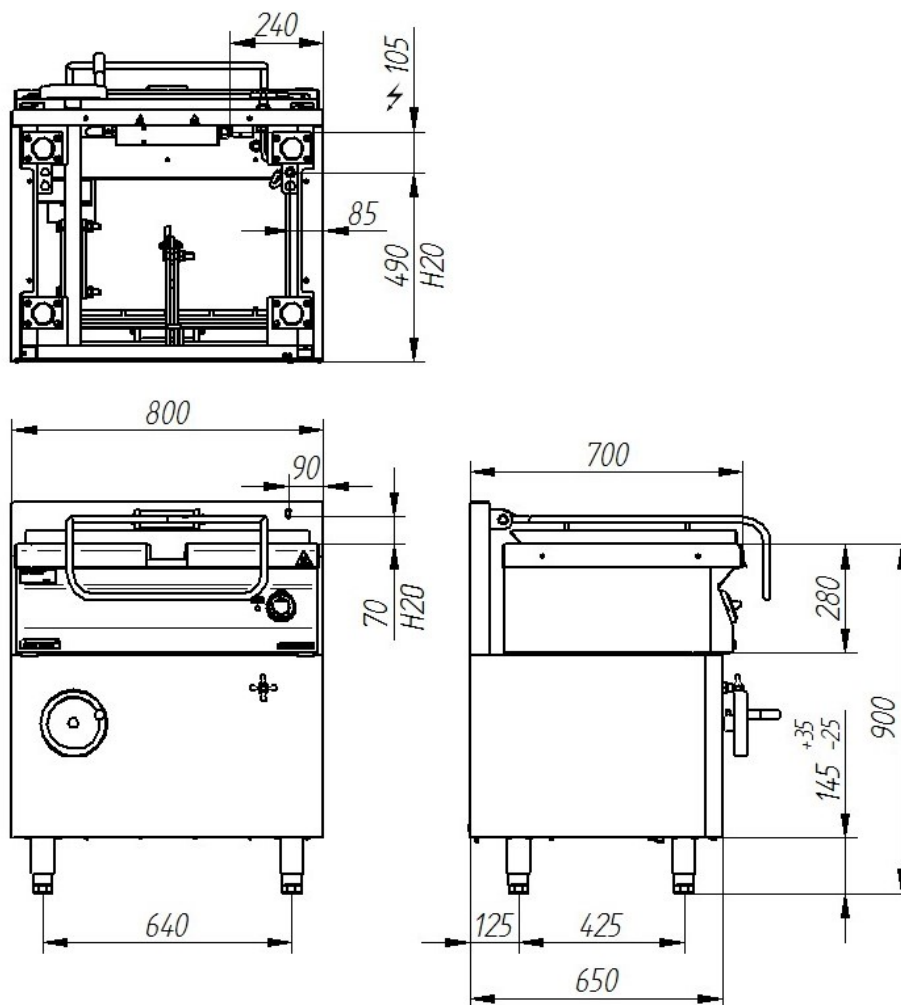

The picture is for reference only; final product may be slightly different from the presented example.