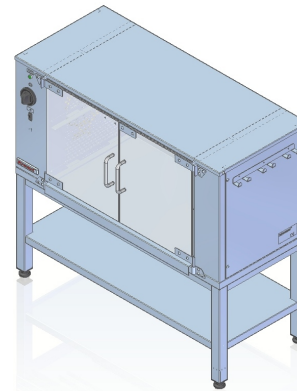
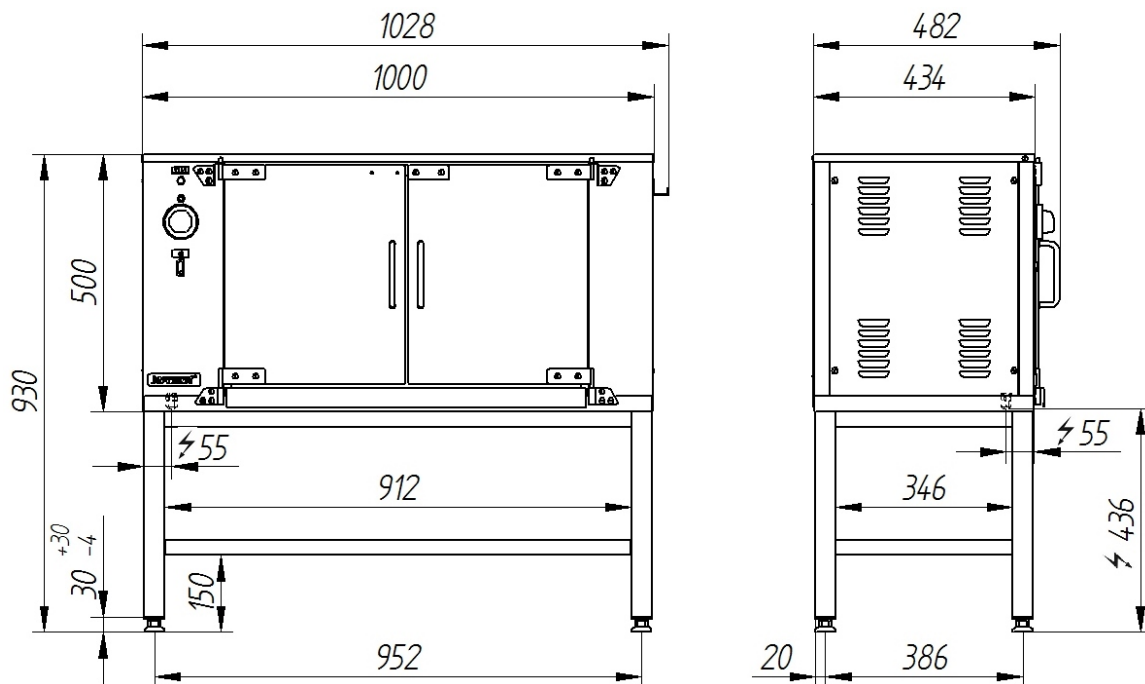

Model:	000.SG-12	1000x434x930 [mm]
	Power rating	1.6 kW
	Temperature range	0°–90°C
Chamber	Chamber dimensions	713x430x434 mm
	Grate dimensions	700x400
	Rated voltage, type of current	230V:50Hz
	Chamber lighting	YES
	Air flow	YES

**Description:**

Electric heating cabinet with air flow is made of high-grade stainless steels. Heating element with fan ensures uniform temperature distribution. Two levels for grates. Long-life, fast heating elements. Bar grates included. Glass door for viewing of products being heated. Glass provided on device rear. Drip tray. Hanger for any additional forks mounted on device side. As an option, rotating spit 000.OE-12 can be ordered and installed in heating cabinet.

000.SG-12

The picture is for reference only; final product may be slightly different from the presented example.