

Model:	000.PE-025p	700x600x850 [mm]
Power rating	6,5 kW	
Capacity	37 dm ³	
Working area	0.25 m ²	
Temperature range	50–250°C	
Bowl dimensions	565x425x150	
Rated voltage, type of current:	400V 3N~	

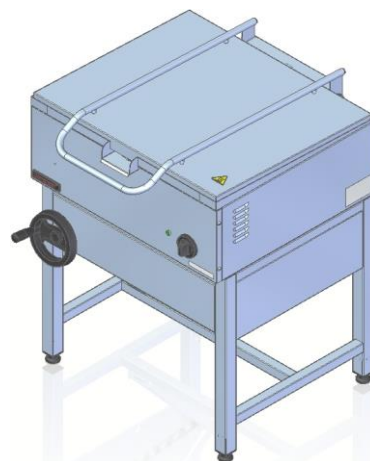

Description:

Electric pans are made of high-grade stainless steels. Working bottom made of AISI 304 stainless steel. Bowl bottom ensures uniform temperature distribution. Pan with manual bowl tilting. Turn wheel for lifting and lowering of the bowl. Bowl tilting up to 45°C. Setting of cover in any position under an angle from 0° to 90°.

000.PE-025p

Location of drain grid

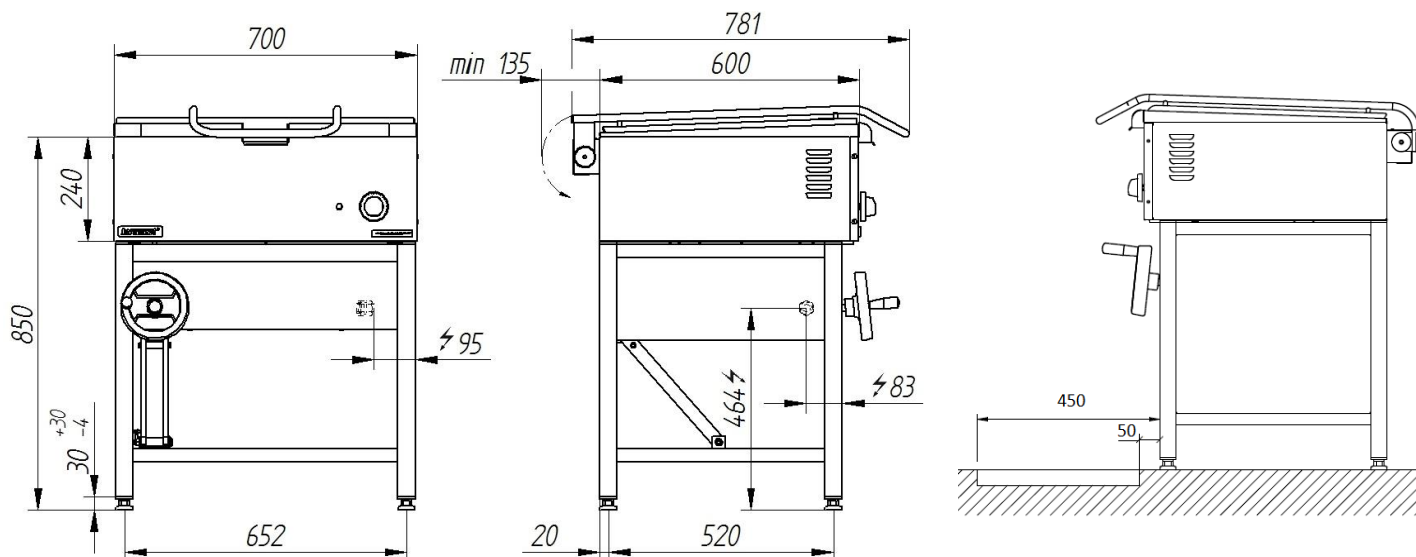

The picture is for reference only; final product may be slightly different from the presented example.

60 LAT
NA RYNKU

Tradition and experience