

|                        |                          |   |   |
|------------------------|--------------------------|---|---|
| <b>Model:</b>          | <b>000.KG-2M</b>         | 400x700x850 [mm]  |   |
| <b>Burners</b>         | <b>Number</b>            | 1   | 1   |
|                        |                          | 104 mm  | 128 mm  |
|                        | <b>Ø</b>                 |  |  |
| <b>Power rating</b>    |                          | 4.5 kW  | 7.5 kW  |
|                        |                          | 3870 kcal/h   | 6450 kcal/h   |
| <b>Power rating</b>    |                          | 12 kW   |   |
| <b>Gas connection</b>  |                          | R1/2  |   |
| <b>Gas consumption</b> | <b>E G20 [20mbar]</b>    | m <sup>3</sup> /h   | 1.42  |
|                        | <b>Lw G27 [20mbar]</b>   | m <sup>3</sup> /h   | 1.65  |
|                        | <b>3B/P G30 [37mbar]</b> | kg/h  | 1.00  |

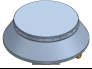
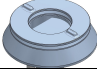

### Description:

Gas cooker is made of high-grade stainless steels. Burners and grates made of cast-iron. Removable bowls for liquids ejected when cooking under burners. Cooker is equipped with storage shelf. Adjustable burner power. Cooker is equipped with pilot burner with flame safety device. Grill adapters (smooth, grooved), reduction adapters and Wok grate can be used.

### 000.KG-2M

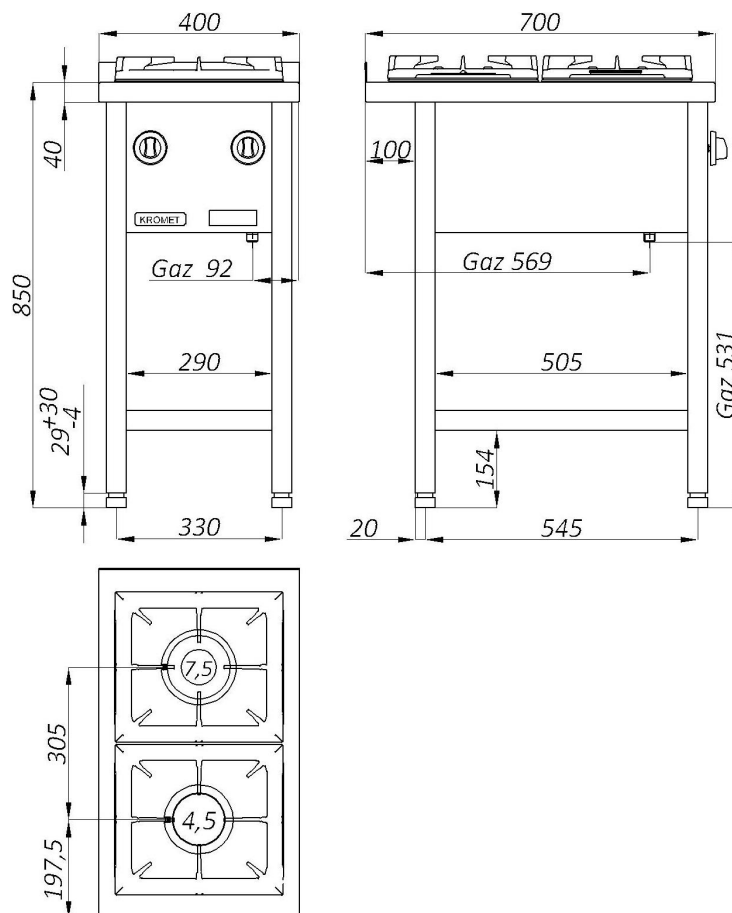

The picture is for reference only; final product may be slightly different from the presented example.

**60 LAT**  
NA RYNKU

Tradition and experience